

8FT Elegance II Vertical Serpentine To Install

Frame Installation

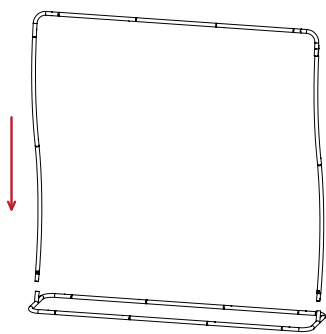
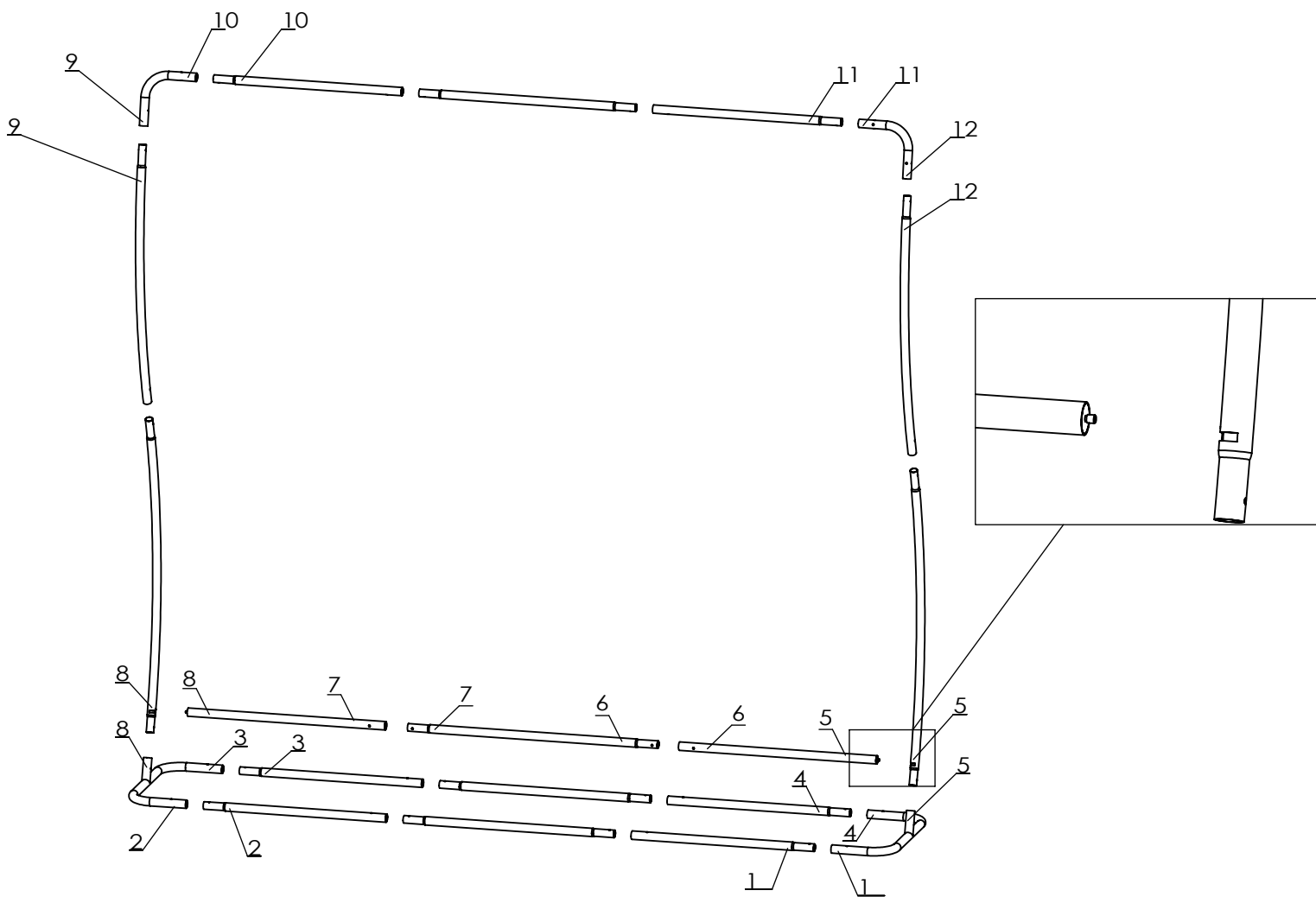

step 1:

There are some figures labeled on every tubes, connecting the same figures together to make up of the frame.
(Please noted that don't install the Horizontal tube now)

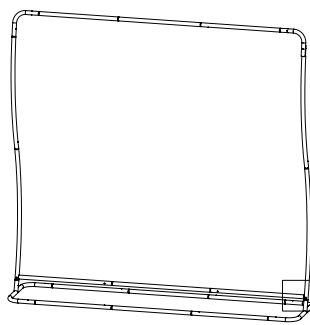
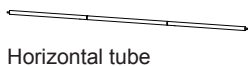

step 2:

Assemble horizontal tube

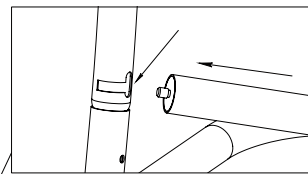

The horizontal tube aims at the slot, push and put it in the down slot.

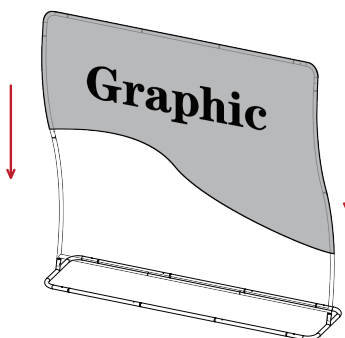

step 3:

Put the Graphic on the ready Frame

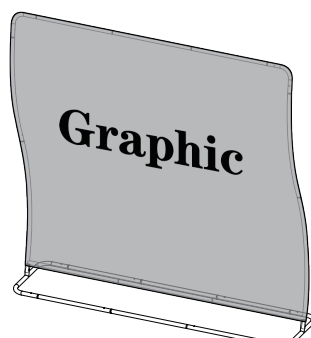

step 4:

Completed.