

# SET UP INSTRUCTIONS for Pop Up Display

**1. Place the frame** on the ground with the brackets at the top **(a)**.

**2. Attached the lights.**

- First attach the power cord to the light fixture.
- Next, make sure the light brackets are facing up **(b)**.
- Then slide the light fixture onto the bracket **(c)**

**3. Expand the frame.**

- Pull upwards on the frame
- It will self-lock in the expanded position **(d)**

**4. Attach the channel bars.**

- 4 black channel bars go on the 4 outer lower positions (there is velcro which holds down the lower corner of the end caps).
- Start at the top of the frame, insert the pointed end of the channel bar into the slot in the bracket at the top of the frame **(e)**
- Slide the bottom of the channel bar from right to left onto the metal peg **(f)**
- Continue with the middle and lower channel bars.

**5. Attach the four center panels.**

- Start at one end and work your way across the frame.
- The panel have a slot at the top that slides onto pin at the top of the frame **(g&h)**.
- One both sides are attached to the pins, work your way down, aligning the magnetic strips.

**6. Attach the two end cap panels.**

- Slide one end onto the pin at the top of the frame.
- Then, be sure to hold the panel close to the top and attach the other side, this will allow the panel to bend into a curve.
- Work your way down the panel and attached the velcro at the bottom.

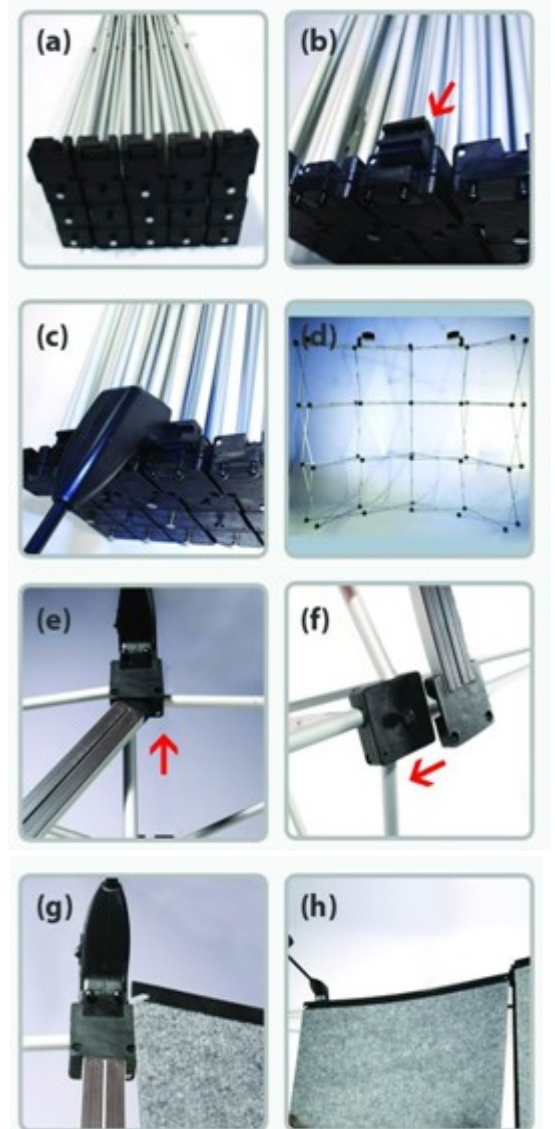

## DISASSEMBLING

**1. Start by removing all panels.**

Pull off the panels starting at the bottom, once the magnet is disconnected, push the whole panel up to unhook the top from the frame

**2. Remove channel bars** Start at the bottom.

Hold the square at the bottom of the channel bar and push it to the right, once it has come off of the metal pin, pull the channel bar down so that it comes out of the bar above it.

**3. Pack channel bars** into nylon bag.

**4. Collapse frame**

By pushing the hubs away from each other.

**5. Put the frame back** into it's nylon bag.

**6. remove the lights .**

## REPACKING THE DISPLAY

**1. Put the lights and wire** into the lid.

**2. put the frame, channel bars back** into the bag.

**3. Roll all panels** and put them into the bag  
Do not roll fabric side in! Make sure when you roll the fabric panel that the fabric is to the outside.